

P360 Gen II Series

Portable LED Light

User Manual

Fiilex

Table of Contents

What's in the Box	1
Light Components	2
Setup and Basic Operation	4
Optional Accessories	6
Specifications	8
For Your Safety	9

What's in the Box

- P360 Classic / Pro / Pro Plus
- 4 Leaf Barndoor Set

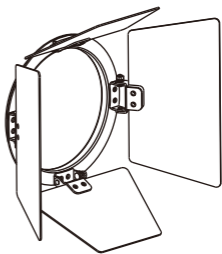
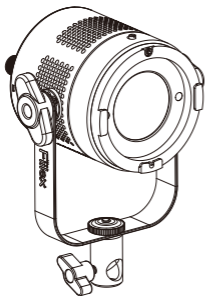

- Power Adapter

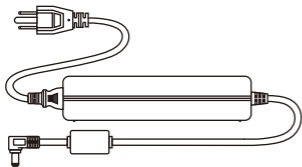

Light Components

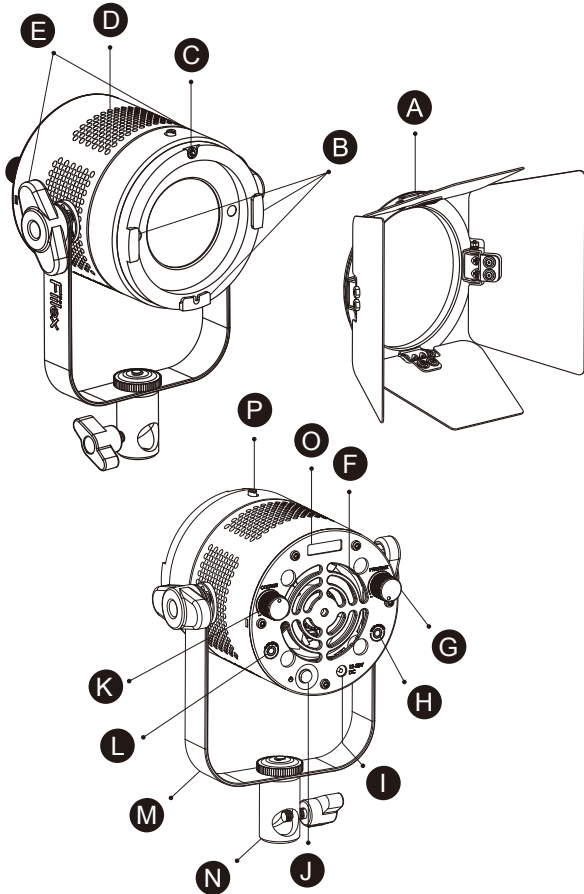

- A 4 Leaf Barndoor
- B Barndoor Brackets
- C Accessory Lock
- D Side Vents
- E Yoke Knobs
- F Rear Vents
- G Light Intensity / DMX Address Knob (DMX: P360 Pro / P360 Pro Plus Only)
- H Light Control Output Jack (P360 Pro / P360 Pro Plus Only)
- I DC Power Input Jack
- J On / Off Button
- K CCT / Hue Tuning Knob (Hue: P360 Pro Plus Only)
- L Light Control Input Jack (P360 Pro / P360 Pro Plus Only)
- M Yoke
- N Light Stand Adapter
- O OLED Display (P360 Pro / P360 Pro Plus Only)
- P Accessory Lock Release

Setup and Basic Operation

Initial Setup

1. Mount Light Stand Adapter (O) to 5/8" Stud on light stand.
2. Slide Barndoors into Barndoor Brackets (B) until Accessory Lock (C) clicks.
To release Barndoors, slide back Accessory Lock Release (Q) and slide Barndoors out of Barndoor Brackets (B).
3. Insert DC power plug from power adapter into DC Power Input Jack (I).
4. Connect Power Adapter to AC Power.
5. Press On/Off Button (J) to activate light.

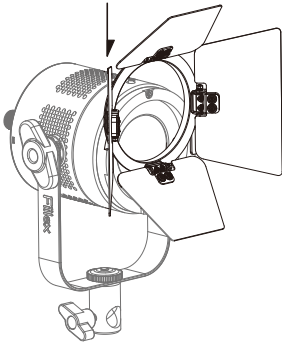

Light Settings

- Turn CCT Tuning Knob (K) to adjust color temperature (2800-6500K).
- Turn Intensity Knob (G) to adjust light intensity (0-100%).
- (Pro Plus only) Double click CCT / Hue Tuning Knob (K) to enter hue tuning mode, then turn knob to adjust hue (± 0.25 green). To return to CCT tuning mode, click knob (K) again or wait 3 seconds.

DMX (Pro / Pro Plus only)

1. Insert phone jack (TRRS) connector into Light Control Input / Output Jack (H/L).
2. Double click Intensity / DMX Address Knob (G) to enter DMX address edit mode, then turn knob to select address. To return to intensity adjustment mode, click knob (G) again or wait 3 seconds.

DMX connection requires three-ring TRRS phone jack.

Cable Adapter accessories are available to facilitate DMX connection via RJ45 and XLR.

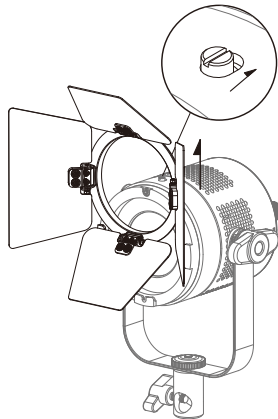

Optional Accessories

Fresnel Lens

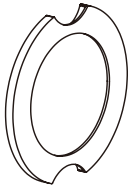

Dome Diffuser

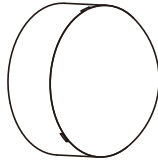

Power Adapter Holder

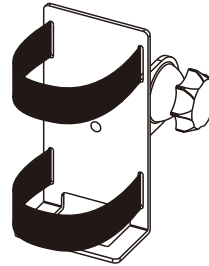

DMX Controller

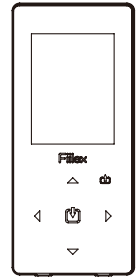

D-tap Cable

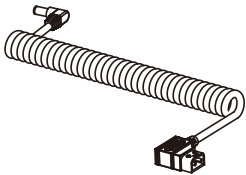

Softbox

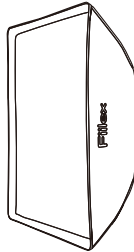

XLR Unit Link Adapter

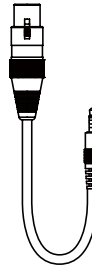

RJ45 Unit Link Adapter with RJ45 Coupler

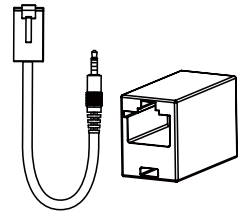

For additional accessories go to www.filex.com

Specifications

Size (without Barndoor)

4" x 4.7" / 102mm x 119mm

Weight (Includes Yoke)

1.6 lb / 0.74 kg

LED

Dense Matrix LED

Thermal Design

Advanced Cooling System

CCT Range

2800-6500K Continuous Tuning

Hue Range (Pro Plus only)

-0.25 to +0.25

CRI

>93

Power Consumption

90W Max.

Power Input

12 to 30V DC

AC Adapter

100-240V AC, 50/60Hz (In) / 24V DC, 90W max. (Out)

Operating Temperature

0° to 40°C / 32° to 104° F

IP Rating

IP-24

For Your Safety

- Do not attempt to disassemble the body of the P360, doing so will immediately void the factory warranty.
- Do not install the P360 in a damp or wet area.
- Do not submerge P360 in water.
- Do not cover the side or back air vents.
- Only use the included power adapter, failure to do so may cause damage to the LED light.
- Only use a soft, dry towel to gently clean the exterior of the light.
- Before using the light for the first time, remove the protective membranes.

Fiilex

Fiilex.com

1689 Regatta Blvd. Richmond, CA 94804

(510)620-5155 . Fiilex@Fiilex.com

Information and Specifications in this document are subject to change without notice. DiCon Lighting, Inc. assumes no responsibility or liability for any error or inaccuracies that may appear in this manual. Unlawful reproduction or distribution in any manner without the written permission of DiCon Lighting, is strictly prohibited.

© DiCon Lighting 1996-2017 All Rights Reserved

Fiilex



Fiilex.com