

FEATURES

- 2800-6500K continuous CCT tuning
- 300W tungsten output (90W draw)
- High CRI values at every color temperature
- ± 0.25 green adjustment
- Dims to 0% without flicker or color shift
- Precise color calibration for consistent quality
- OLED display for monitoring settings
- DMX controllable (3-channels: intensity, CCT, hue)
- Water resistant (IP-24)
- Weighs less than 2 lbs
- Supports 12-30V battery input with D-Tap accessory
- Available in portable three-light kits



COMPREHENSIVE COLOR CALIBRATION

ensures cinema-caliber precision and light quality at all settings

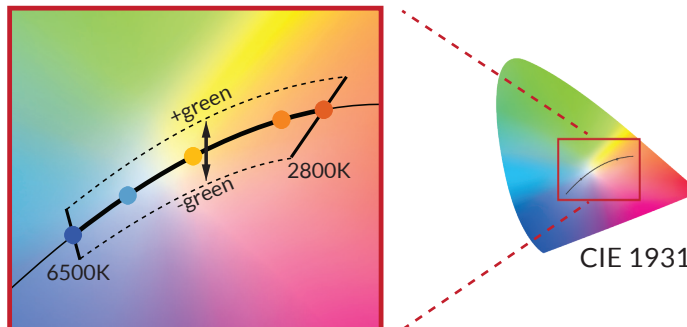

MULTI-PHOSPHOR SPECTRUM for excellent color rendering

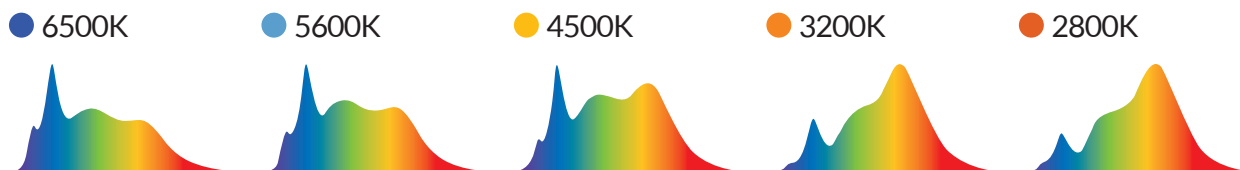

Industry-leading CRI scores on difficult color samples (R9, R12)

| CCT | R1 | R2 | R3 | R4 | R5 | R6 | R7 | R8 | R9 | R10 | R11 | R12 | R13 | R14 | R15 | CRI _{Ra} * | CRI _{Ext} * | TLCI |
|-------|----|----|----|----|----|----|----|----|----|-----|-----|-----|-----|-----|-----|---------------------|----------------------|------|
| 3200K | 98 | 99 | 95 | 98 | 98 | 98 | 98 | 97 | 95 | 97 | 98 | 88 | 98 | 96 | 97 | 97 | 97 | 98 |
| 5600K | 98 | 99 | 98 | 96 | 96 | 97 | 97 | 96 | 90 | 96 | 96 | 89 | 98 | 98 | 97 | 97 | 96 | 98 |
| 6500K | 98 | 98 | 98 | 96 | 97 | 98 | 97 | 97 | 95 | 97 | 97 | 89 | 98 | 99 | 97 | 97 | 97 | 99 |

*CRI_{Ra} is the averaged result of R1 to R8; CRI_{Ext} is the averaged value of R1 to R15. Typical values shown.

PHOTOMETRIC DATA

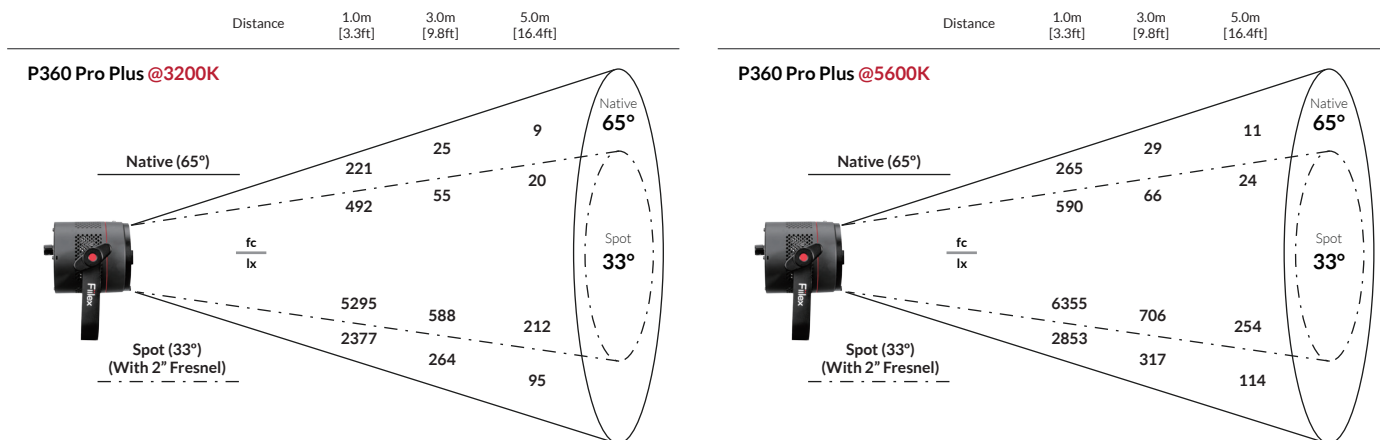

SPECIFICATIONS

| | |
|-----------------------|--|
| Beam Angle | 65° (33° With 2" Fresnel, 12° With 5" Fresnel) |
| CCT Range | 2800 - 6500K Continuous Tuning |
| CRI | 97 Typical |
| Hue | ±0.25 Green |
| Dimming | 100% - 0% Flicker Free |
| Light Engine | Dense Matrix LED |
| Power Draw | 90W Max |
| DC Input | 12 - 30V DC (80W DC Max) |
| AC Input | 100 - 240V AC, 50 ~ 60Hz |
| DMX Control | 3-CH (Intensity, CCT, Hue) via TRRS Ports |
| Display Type | OLED |
| Weight | 1.9lbs / 0.8kg |
| Size (L x W x H) | 5.9in x 4.7in x H 8.1in / 15.0cm x 11.9cm x 20.6cm |
| Mount | Baby Stud 5/8" Female (16mm) |
| IP Rating | IP-24 (Dust & Water Resistant) |
| Thermal Design | Advanced Vapor Cooling System (Fan Cooled) |
| Operating Temperature | 32 - 104°F / 0 - 40° C |

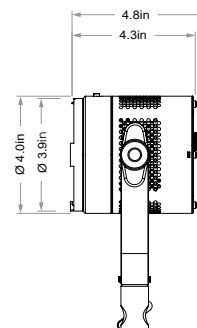
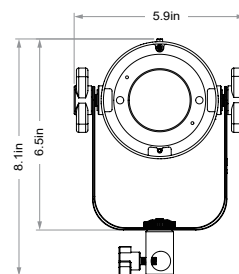

OPTIONAL ACCESSORIES & KITS

